

Lowestoft Flood Protection Scheme

Hamilton Road

What are we updating you about?

Following the completion of the tidal flood walls in 2023, we have inspected the tidal flood walls and found some defects that need attention. This factsheet is providing an update on the repairs to the defects in the tidal walls on Hamilton Road.

The tidal flood walls are part of the Lowestoft Flood Protection scheme and are a mixture of glass topped flood walls, concrete flood walls, demountable defences (put in place ahead of a tidal surge) and flood gates.

The tidal flood walls will provide the town with vital protection in the event of a tidal surge. We are grateful for your cooperation as repairs take place on these vital defences and apologise for any inconvenience caused.

The planned work will ensure that Lowestoft, its people, and its economy are protected for many years to come.

Where is this work happening?

The repairs to the tidal flood walls will take place on Hamilton Road. A map of where the work is taking place is on page 2 of this factsheet.

When are we doing the work?

The repairs will start on 1st July and are due to be completed in approximately 3 weeks.

What will we be doing?

The works will include repairs of cracks in the concrete of the tidal flood walls.

Traffic management with single lane closures will be in place along Hamilton Road. Pedestrian access routes will be managed around the works. Diversions will be clearly signed. Details of the traffic management plans are on page 3 of this factsheet.

Why are we doing this work?

In December 2013 communities, businesses, roads, rail and services in Lowestoft were significantly impacted upon by an East Coast tidal surge. Over 150 homes and businesses flooded. The planned work will ensure that Lowestoft, its people and its economy are protected for many years to come.

This, as well as the other projects in Lowestoft, will allow the Town to grow and develop benefitting the economy, creating more jobs and keeping people and homes safe from future tidal surges.

Lowestoft Flood Protection Scheme Hamilton Road

How can you find out more?

We hope this factsheet has been both helpful and informative. If you would like further details about the project, please visit www.lowestoftfloodprotection.co.uk/

To find out more about these works or the project please email coastalmanagement@eastsoffolk.gov.uk

You can follow us on social media:

Twitter: @CPE_NandS | @EastSuffolk

Facebook: @CPENandS | @EastSuffolkCouncil

Instagram: @cpe_nands | @eastsoffolkcouncil

Location Map

Red box showing location of works.



Lowestoft Flood Protection Scheme Hamilton Road

Traffic Management Plans

Traffic Management Plan phase 1: 3rd -15th July.

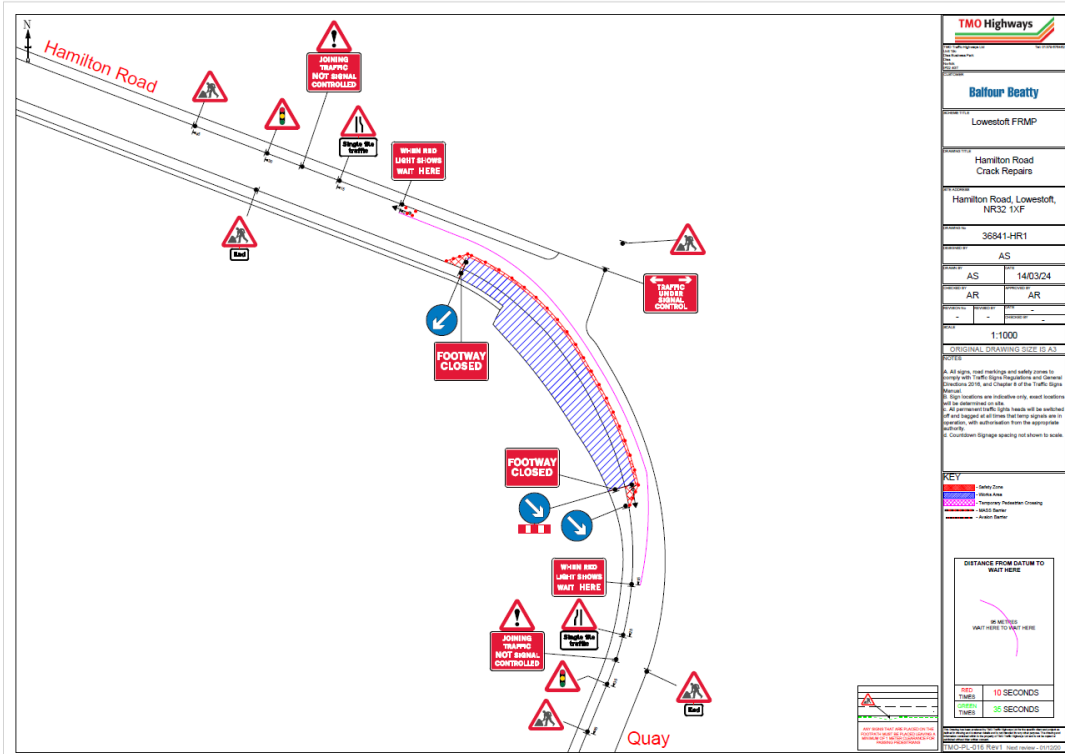

Traffic Management Plan phase 2: 15th – 22nd July.

